

02-09-99

RESOLUTION NO. M-3215

9189-9

A RESOLUTION fixing March 15, 1999, as the date for public hearing on a proposal to vacate a portion of a tract of land lying in the Amos Short Donation Land Claim and in the NW ¼ of Section 27, T2N, R1E of the Willamette Meridian: (a) east line of Lincoln Street to west line of Markle; (b) east line of Markle to west line of Kauffman; (c) east line of Kauffman to west line of Harney; and, (d) a tract of land known as Daniels Street - north of the north line of Mill Plain Extension and south of the south line of 15th Street.

NOW, THEREFORE,

BE IT RESOLVED BY THE CITY OF VANCOUVER:

Section 1. As recommended in SR 034-99, City Council, pursuant to RCW 35.97.010, hereby initiates procedures to vacate that portion of a tract of land lying in the Amos Short Donation Land Claim and in the NW ¼ of Section 27, T2N, R1E of the Willamette Meridian: (a) east line of Lincoln Street to west line of Markle; (b) east line of Markle to west line of Kauffman; (c) east line of Kauffman to west line of Harney; and, (d) a tract of land known as Daniels Street - north of the north line of Mill Plain Extension and South of south line of 15th Street.

Section 2. The legal description of the street areas proposed to be vacated is attached hereto and incorporated herein as Exhibit "A".

Section 3. On Monday, March 15, 1999, at the hour of 7:00 p.m. in Council Chambers in City Hall, 210 East 13th Street, Vancouver, Washington, is fixed as the time and place for the hearing on said proposed street vacation.

Section 4. The City Clerk shall give notice of the pendency of said proposal and time and place of hearing, as required by RCW 35.79.020.

ADOPTED at regular session of the Council of the City of Vancouver, this 16th day of February, 1999.



Royce E. Pollard, Mayor

Attest:



H. K. Shorthill, City Clerk
By: Judith Hoggatt, Deputy

Approved as to form:

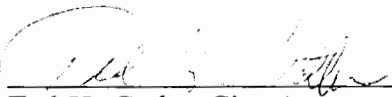

Ted H. Gathe, City Attorney

G9020901/TG:MW

LEGAL DESCRIPTION

A tract of land lying in the Northwest $\frac{1}{4}$, Section 27, T 2 N, R 1 E of the Willamette Meridian, Clark County, Washington and as shown on the Right-Of-Way Plan, Mill Plain Blvd. Extension - Urban Segment, Sheet 6 of 8, dated September, 1997, said tract being more particularly described as follows:

All of that portion of Daniels Street lying North of the North line of said Mill Plain Extension and South of the South line of 15th (Fifteenth) Street being 80.00 (eighty) feet in width.

Contains 11,678 sq. ft.

SURVEYOR'S CERTIFICATE

I, Thomas W. Ray, being registered as a Professional Land Surveyor under the laws of the State of Washington do hereby certify that this legal description was prepared by me or under my direction.

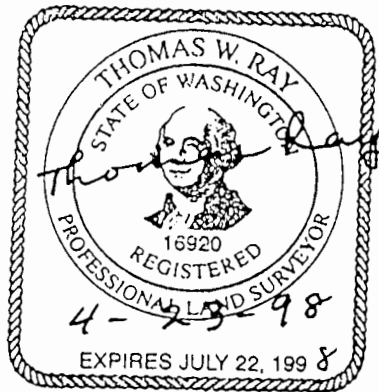

A tract of land lying in the Amos Short Donation Land Claim and in the NW 1/4 of Section 27, T2N, R1E of the Willamette Meridian, Clark County, Washington said tract being more particularly described as follows:

The South 10.00 [ten] feet of West 15th Street, as shown on Book 40 of Surveys, page 73, records of said county, that is bounded on the West by the northerly extension of the East line of Kauffman Street and on the East by the northerly extension of the West line of Harney Street.

Except that portion of the above described tract the lies northeasterly of a line that begins at a point on the North line thereof that is 20.00 [twenty] feet distant from its northeast corner and ends at a point on the East line thereof and is 10.00 [ten] feet distant from its northeast corner.

Also except that portion of the above described tract that lies northwesterly of a line that begins at a point on the North line thereof that is 20.00 [twenty] feet distant from its northwest corner and ends at a point on the West line thereof and is 10.00 [ten] feet distant from its northwest corner.

contains 3,330 square feet

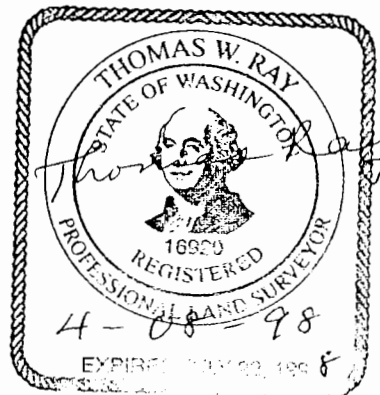

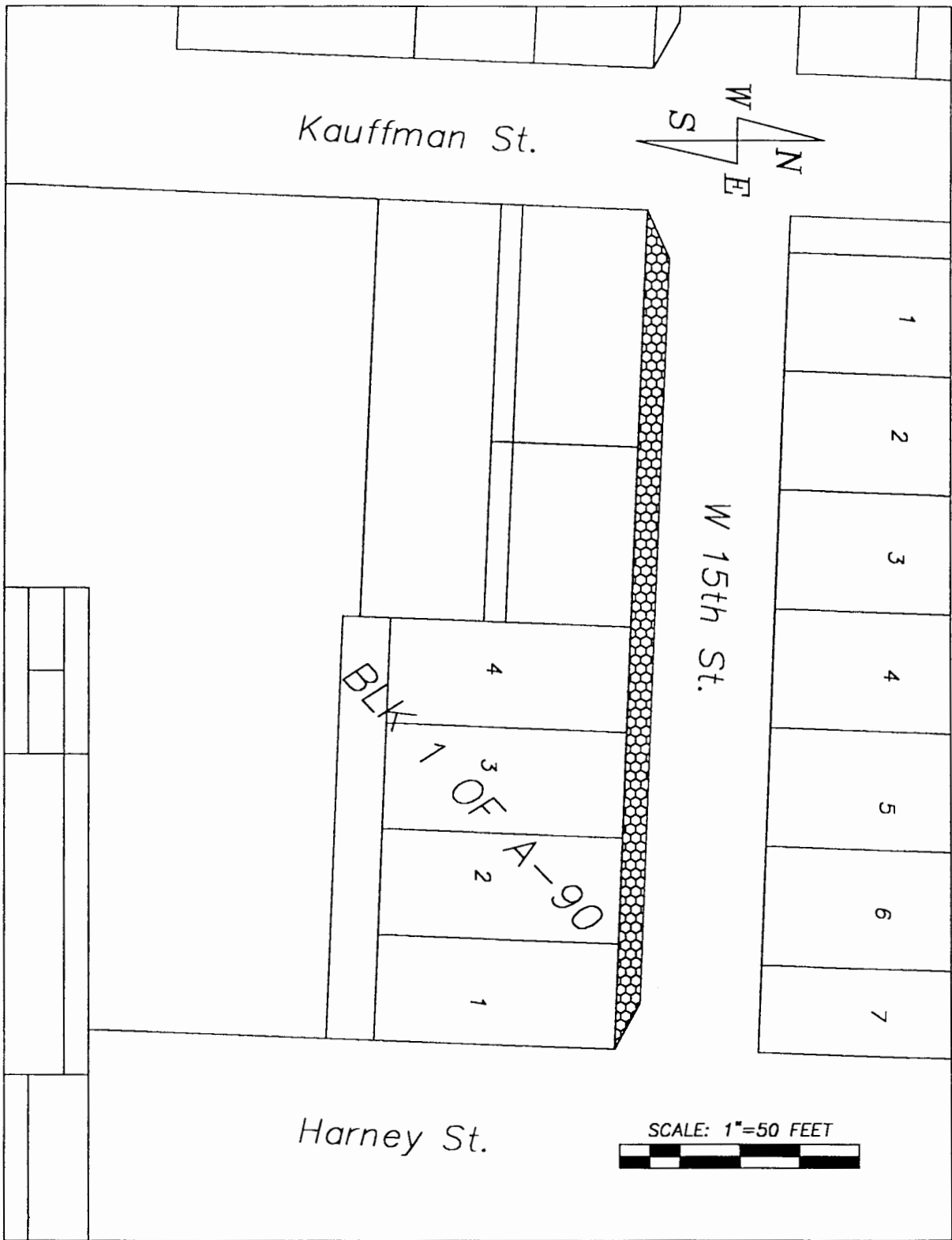

Kauffman St.

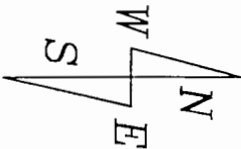

W 15th St.

BLK
7 OF
A-90

Harney St.

SCALE: 1"=50 FEET



A tract of land lying in the Amos Short Donation Land Claim and in the NW 1/4 of Section 27, T2N, R1E of the Willamette Meridian, Clark County, Washington said tract being more particularly described as follows:

The South 10.00 [ten] feet of West 15th Street, as shown on Book 40 of Surveys, page 73, records of said county, that is bounded on the West by the northerly extension of the East line of Lincoln Street and on the East by the northerly extension of the West line of Markle Street.

Except that portion of the above described tract the lies northeasterly of a line that begins at a point on the North line thereof that is 20.00 [twenty] feet distant from its northeast corner and ends at a point on the East line thereof and is 10.00 [ten] feet distant from its northeast corner.

Also except that portion of the above described tract that lies northwesterly of a line that begins at a point on the North line thereof that is 20.00 [twenty] feet distant from its northwest corner and ends at a point on the West line thereof and is 10.00 [ten] feet distant from its northwest corner.

contains 2,070 square feet

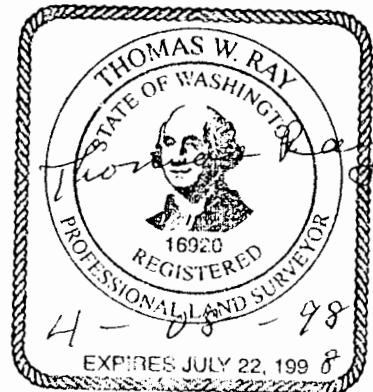

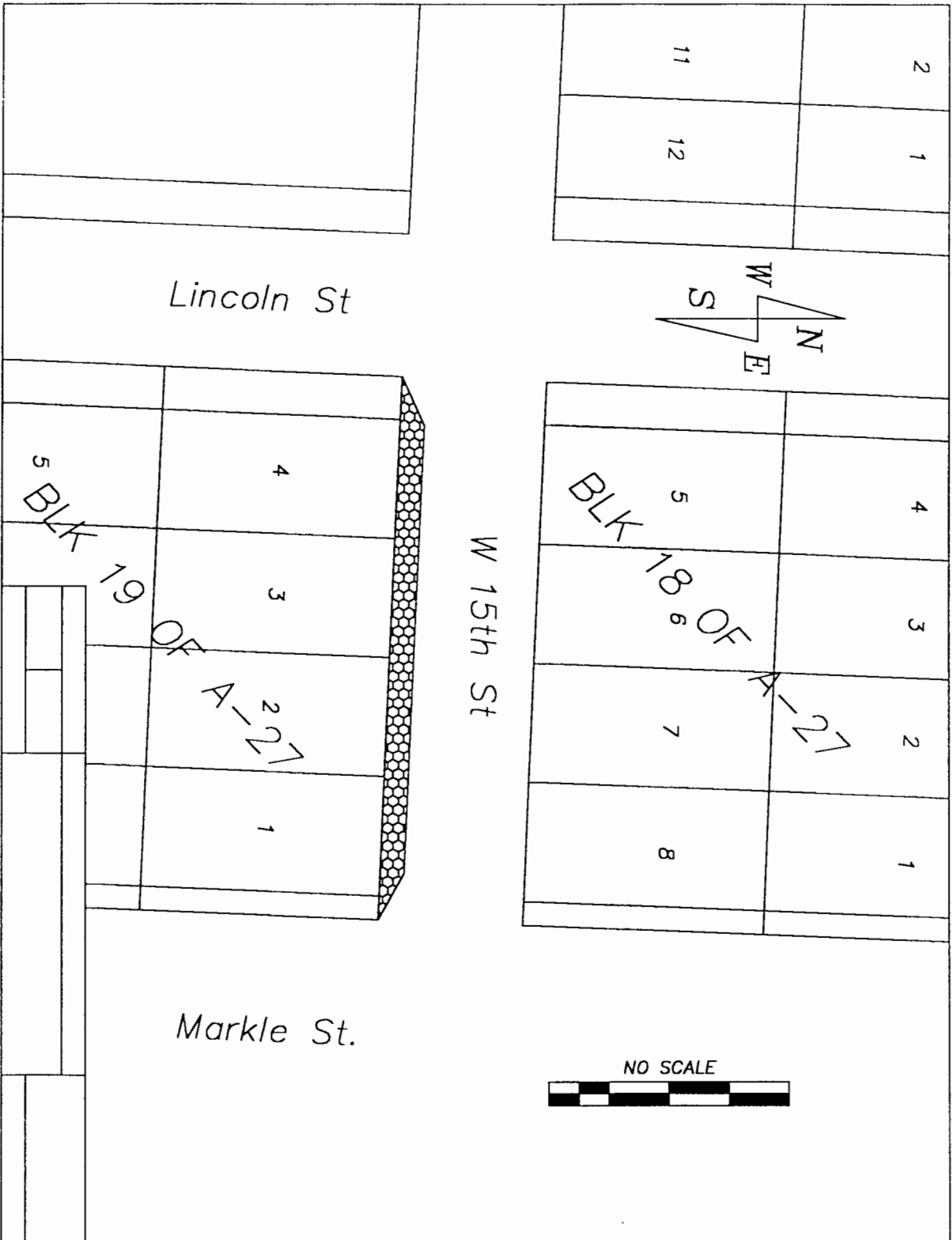

A tract of land lying in the Amos Short Donation Land Claim and in the NW 1/4 of Section 27, T2N, R1E of the Willamette Meridian, Clark County, Washington said tract being more particularly described as follows:

The South 10.00 [ten] feet of West 15th Street, as shown on Book 40 of Surveys, page 73, records of said county, that is bounded on the West by the northerly extension of the East line of Markle Street and on the East by the northerly extension of the West line of Kauffman Street.

Except that portion of the above described tract the lies northeasterly of a line that begins at a point on the North line thereof that is 20.00 [twenty] feet distant from its northeast corner and ends at a point on the East line thereof and is 10.00 [ten] feet distant from its northeast corner.

Also except that portion of the above described tract that lies northwesterly of a line that begins at a point on the North line thereof that is 20.00 [twenty] feet distant from its northwest corner and ends at a point on the West line thereof and is 10.00 [ten] feet distant from its northwest corner.

contains 2,070 square feet

